

# DIVINE LIVING

ARJAN



TAKMEEL  
REAL ESTATE DEVELOPMENT







# DIVINE LIVING

## ARJAN

DrivenPropertiesproudlypresentsthelatestproject  
by Takmeel Development, Divine Living, Arjan.

This off plan residential project represents a true  
quiet oasis in a buzzing city. Divine Living offers  
a remarkable combination of spacious layouts  
and beautiful designs. The finish of the building  
is carefully crafted to represent a timeless  
aesthetics that is both natural and elegant,  
created to suit the taste of modern homebuyers.







# LOCATION MAP

The community features residential complexes, commercial buildings and retail developments.

Although residential and peaceful, the luxurious residences offer direct and quick access to Sheikh Zayed Road and Umm Suqeim Street allowing fast reach to the whole city.



**02 MINUTES**  
TO BARSHA  
CITY CENTRE

**05 MINUTES**  
TO UMM  
SUQEIM ROAD

**20 MINUTES**  
TO BURJ KHALIFA

**20 MINUTES**  
TO DUBAI MARINA

**20 MINUTES**  
TO AL SUFOUH  
BEACH

**25 MINUTES**  
TO DUBAI  
INTERNATIONAL  
AIRPORT



# PLOT LOCATION

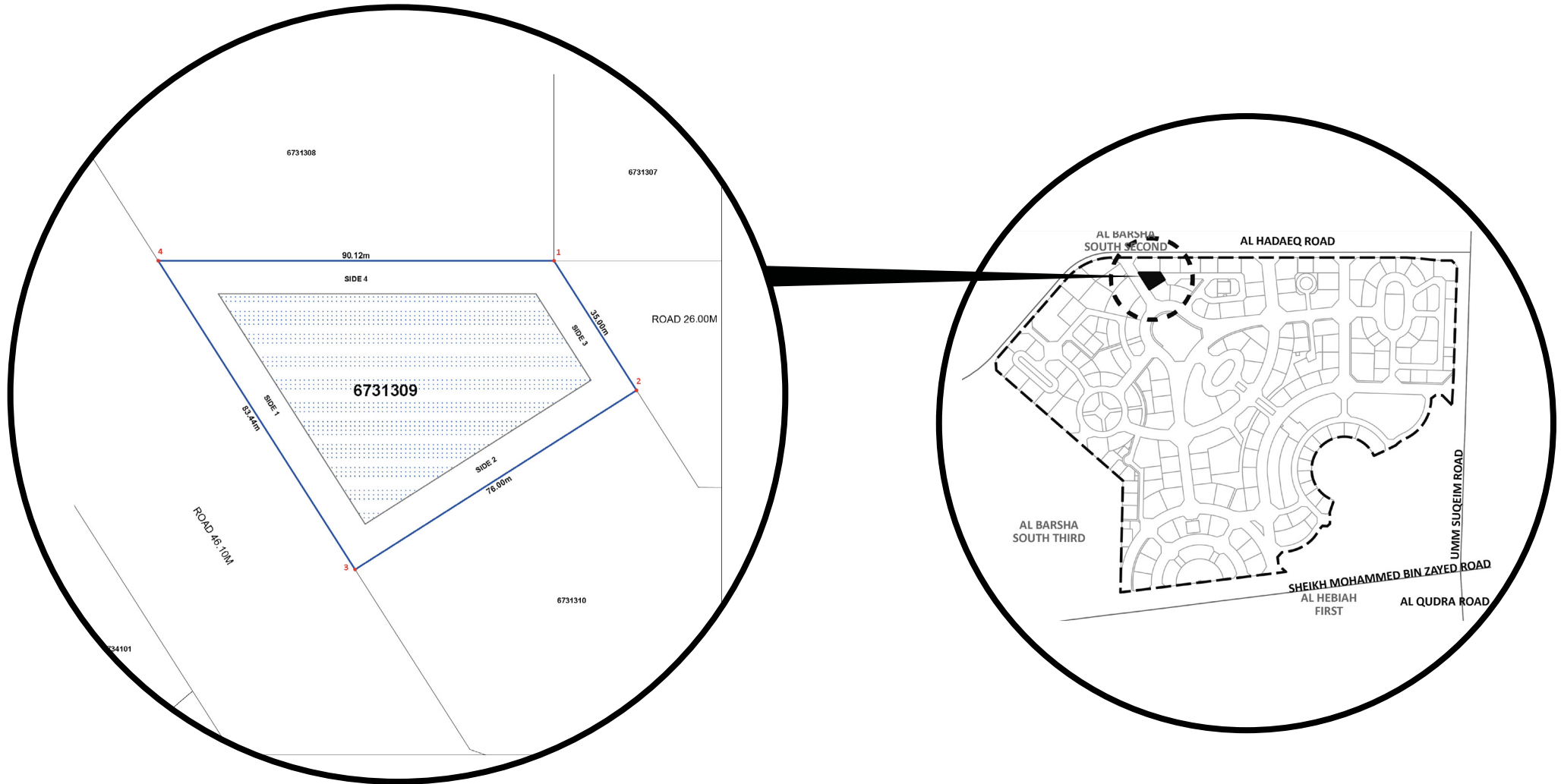



## IN THE HEART OF A THRIVING COMMUNITY



The neighborhood is particularly popular for having two of the most visited parks in Dubai: Dubai Miracle Garden and Dubai Butterfly Garden. Since this community is fairly new, the general feel of the community is quiet and peaceful.

The roads are free of excessive noise and traffic.



TIMELESS  
ELEGANCE,  
WITH A COLOR  
PALETTE THAT  
IS BOTH  
CONTEMPORARY  
AND TIMELESS.





# PROJECT HIGHLIGHTS



World Class  
Materials



High Quality  
Finishing



Financing  
Available



Thriving  
Neighbourhood



Family  
Friendly

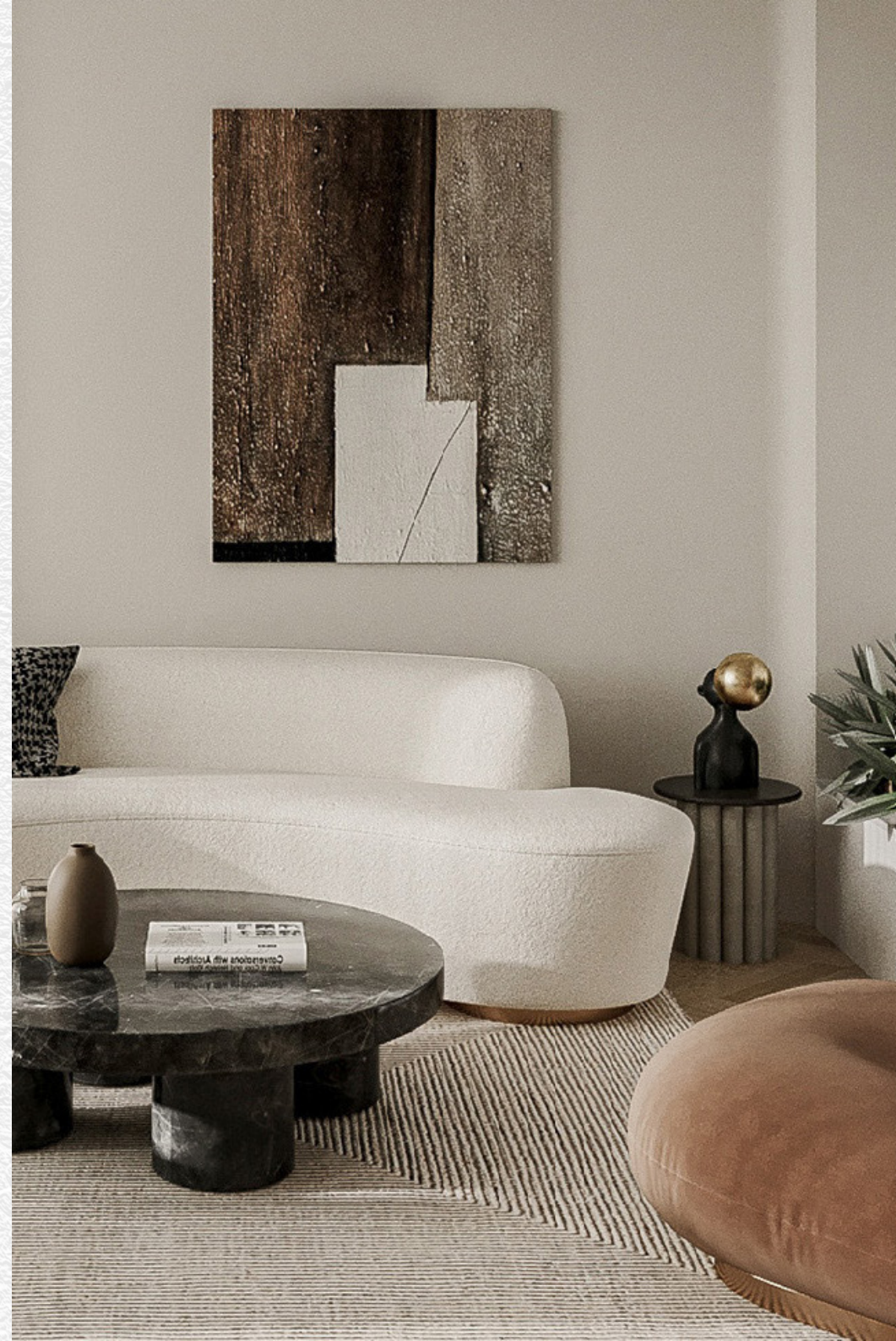



# AMENITIES



Fully Equipped  
Gym



Swimming  
Pool



Children's  
Pool



Children's  
Play Area



Landscaped  
Gardens



Covered  
Parking



3 Lift's /  
Elevators



24/7  
Security



24/7  
CCTV







STEP INTO ELEGANT LIVING

DIVINE  
LIVING  
ARJAN



## UNIT DETAILS





TYPICAL 1 BEDROOM





TYPICAL 1 BEDROOM





TYPICAL 1 BEDROOM





TYPICAL BATHROOM





TYPICAL BATHROOM





TYPICAL BEDROOM





TYPICAL 2 BEDROOM





TYPICAL 2 BEDROOM





TYPICAL 2 BEDROOM





TYPICAL 3 BEDROOM





TYPICAL 3 BEDROOM





TYPICAL 3 BATHROOM





TYPICAL 3 BEDROOM





TYPICAL POWDER BATHROOM 01





TYPICAL POWDER BATHROOM 02





TYPICAL POWDER BATHROOM 03



# GENERAL MATERIALS



FLUTED MARBLE - LOBBY



PORCELAIN TILES - LOBBY



PORCELAIN FEATURE WALL - LOBBY



GENERAL TEXTURED PAINT



TIMBER VINYL FLOORING - GYM



FEATURE BATHROOM TILE



GENERAL WALL + FLOOR TILE



OAK VENEER FOR JOINERY + DOORS



PORCELAIN - KITCHEN TOP/SPLASHBACK



GENERAL SANITARYWARE/ IRONMONGERY



RECONSTITUTED STONE BATHROOM TOPS



LACQUERED MDF/LAMINATE KITCHEN/WARDROBE



# PAYMENT PLAN

CASH PAYMENT PLAN		
Installment No.	Milestone	Payment %
1st	Down Payment Month 0	10%
2nd	Month 2	10%
3rd	Month 7	10%
4th	Month 12	10%
5th	On Completion	60%

2 YEARS POST HANDOVER PAYMENT PLAN		
Installment No.	Milestone	Payment %
1st	Down Payment Month 0	10%
2nd	Month 2	10%
3rd	Month 7	10%
4th	Month 12	10%
5th	On Completion Month 18	10%
6th	After 5 Months From Completion	10%
7th	After 10 Months From Completion	10%
8th	After 15 Months From Completion	10%
9th	After 20 Months From Completion	10%
10th	After 25 Months From Completion	10%